



Item: 4A
Date: 1/17/23

JANUARY 17, 2023

WORKFORCE DEVELOPMENT UPDATES

*EMPOWERING YOUTH TO NAVIGATE THEIR
FUTURE*

FROM LAUNCHING BOATS- to launching leaders...



1947 – Western Boat Builders

2023 – Tacoma Youth Marine Center



PORT OF
HOUSTON
~
WATCO
TERMINAL



LAT / LONG: 12 39' 42" N 109 33' 42"
W
AVG. SPEED OVER GROUND (KTS): 7.3
WIND FORCE: 05 FRESH BREEZE
SWELL HEIGHT (M): 1.9









YOU
ARE
INVITED

JOIN US FOR
THE LONG-AWAITED ARRIVAL OF
MV Dealin-Rogers



To her new home at
the Tacoma Youth Marine Center

SUNDAY, OCTOBER 09, 2022
12:30PM - 4:30PM











WARM WELCOME INTO THE FOSS











~ 342 DAYS ~

- \$3.5 MIL
- TEXAS > CANADA > WA
- HIRED 4 NEW STAFF



SEPTEMBER 26, 2022

**1st Washington State marine science cruise aboard MV Doolin-Rogers
68 High School students**





AWARENESS

ACCESS

ACHIEVEMENT

AWARENESS

TARGET: Middle School students

PROGRAM: Boat field trips. Program partners drive curriculum while on water. YMF crew provide fun first experiences at the helm, tying knots, etc

GOAL: Provide awareness of opportunities for on-water programs and recruit.

3,700 Tacoma middle school students will participate in a 1.5 hr. cruise aboard MV Doolin-Rogers by July 2023

ACCESS

ACHIEVEMENT

AWARENESS



AWARENESS

ACCESS

TARGET: TPS students from SOTA / SAMI at TYMC

PROGRAM: Vessel Operations classes during 3rd and 4th period. Adjunct instructor is shared with YMF and TPS. Classes are held dockside and while underway.

GOAL: Provide access to learning on a workboat with access to docks on the working waterfront. Curriculum includes basic boat knowledge while performing simple deckhand duties to students in marine science classes

ACHIEVEMENT

ACCESS



AWARENESS

ACCESS

ACHIEVEMENT

TARGET: Students and youth from the South Sound, including new youth from school programs.

PROGRAM: Traditional Sea Scout programs with more involved leadership and character development.

GOAL: Focused learning using rank advancement through on-boat training and community involvement. Dedicated youth achieve Quartermaster rank, gain sea time towards licensing and enroll in Maritime schools or go straight to industry.





VESSEL OPERATIONS CLASS

ACCESS



Mon/Thu	38 Students
Tue/Fri	<u>18 Students</u>
	56 TOTAL

Dockside	33 Classes
Underway	<u>11 Classes</u>
	44 Total



September 14, 2022
1st Day of Vessel Operations Class

12/12 Well Done!
Great Work!



Name Tyler Honenitz
Date 9-19-21
Class 4th

Vessel Operations

Day Four Knowledge Check

1. What is a cleat?

A cleat is something used to tie ^{line} rope from boats to other boats or docks to stay still.

2. What is the maritime industry in your own words?

The maritime industry is commerce on water. Main fields of maritime include shipping, navigation, and engineering.

3. What is the 1-10-1 rule?

Awesome! The 1-10-1 rule details cold water safety. 1-1 minute to regulate breathing, 10-10 minutes of meaningful movement, 1-1 hour before you enter hypothermia.

4. What side is the port side?

The left side of the boat (facing the bow).

5. What is the bow of the boat?

The front of the boat.

6. Name three types of materials ships have been made out of?

Wood, steel, and fiberglass.

7. What is the stern of a boat?

The stern is the back of a boat (flat part?).

8. What is a fender?

A material (fibre, air bag) that protects the side of the boat from obstructions.

Knots



Yes
2
Knots

Name Eiden
Date _____
Class 8

What is one knot we tie every day? over hand knot - perfect!

What knot is considered the king of Knots? Bowline

What are two different categories of Knots? Hitches, loops, bends, stopper, slip !!

What are three different materials used for line? Monila, dacron, Nylon well done!

Please label the following knots with there name and uses



1. gentle to fiber best
for keeping a rope end
from fraying

Reef/square knot - !!



1. Used to tie reef points
tied as a slipped hitch to
stop anything that can
sink the boat



1. easy and fast



1. Holds the boat to the
dock so the boat doesn't
float away.



Safety



Ryn

Austin



Safety Stow Plan Project

This project will be worth 110 points

The rough draft will be worth 10 points

The final draft will be worth 100 points

The goal is to make a bird's eye view drawing of the following compartments

- The Galley
- The Forward Quarters
- The Stern
- The Bow
- The Wheelhouse
- Topside

The following pieces of safety equipment are required in your stow plan

- 3 life rings
- Fire wand
- Fire hoses
- EPIRB
- Radar
- Fire Axe
- Ships Bell
- Pike Poles
- Escape Hatch- FQ and SQ
- Emergency Fuel shut off
- Throw bag
- Range- safety rails
- Spot light
- Skiffs
- Life Raft
- Fire Extinguisher
- Charts
- Galley and wheel house type 1 Life Jackets

Well Done Ryn!

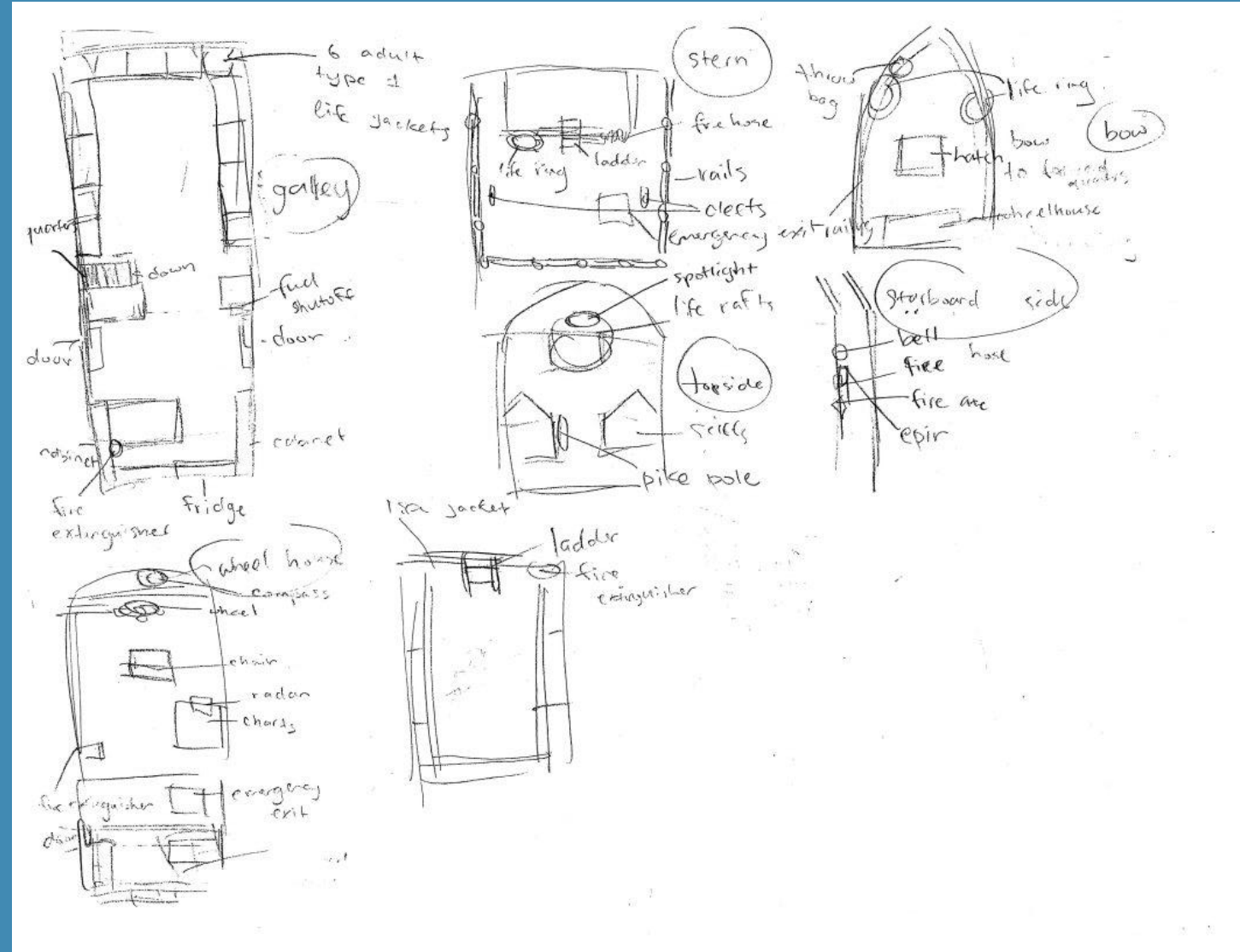

Watch & Underway



What are the duties of the stern lookout?

watching for people overboard or blind spot

What should we do if we see someone in the water?

yell Men overboard

When do we put the fenders when coming back to the dock?

when entering the water way

While on stern watch what is the relative bearing directly behind the ship?

180

When reporting another vessel what details about the vessel should you report?

where it is what kind of vessel

What are the duties of the crew leader?

fill out the watch assignment
and making sure vessel is so when
we come in

What are the duties of the Rover/ runner?

Report when we are on
station

Watch & Underway

4/4

Name yosy limas-C142

Date 11/7/22

Class 3rd

Missed
11/10/22

Watch Assignments

What are the five watches we will be covering during our next underway?

1. ~~times~~ Power
 2. Helm
 3. Log
 4. Stern
- crew leader*

What does Rudder amidship mean?

move the rudder to the middle of the ship
to go forward

If the Captain gives you an order on the helm what are the two responses, you need to give?

1. Acknowledging that I heard
 2. Responding when command complete
- !!

What does steady as she goes mean?

Continue as I go

How many numbers should be in a compass heading?

3 numbers

When should we bring the fender on board?

once it's clear and where good to go forward

Where should the fenders be stored while underway?

the top the stern





MV DOOLIN-ROGERS YOUTH REACH METRICS									
#	MONTH	YOUTH TOTAL	1st TIME YOUTH	% 1st Time Youth	% Returning Youth	INSTRUCTOR TOTAL	GUEST TOTAL	HOURS DOCKSIDE	HOURS UNDERWAY
1	SEPTEMBER	373	373	100%	0%	65	0	0.00	20.00
2	OCTOBER	821	651	79%	21%	195	98	16.00	58.55
3	NOVEMBER	153	52	34%	66%	23	0	3.00	15.15
4	DECEMBER	148	0	0%	100%	18	78	27.00	18.20
	Total 2022	1,495	1,076	72%	28%	301	176	46.00	111.90

EMPOWERING YOUTH TO NAVIGATE THEIR FUTURE

**Thank you,
Commissioners and Port of
Tacoma**

